

Chatillon WT Series

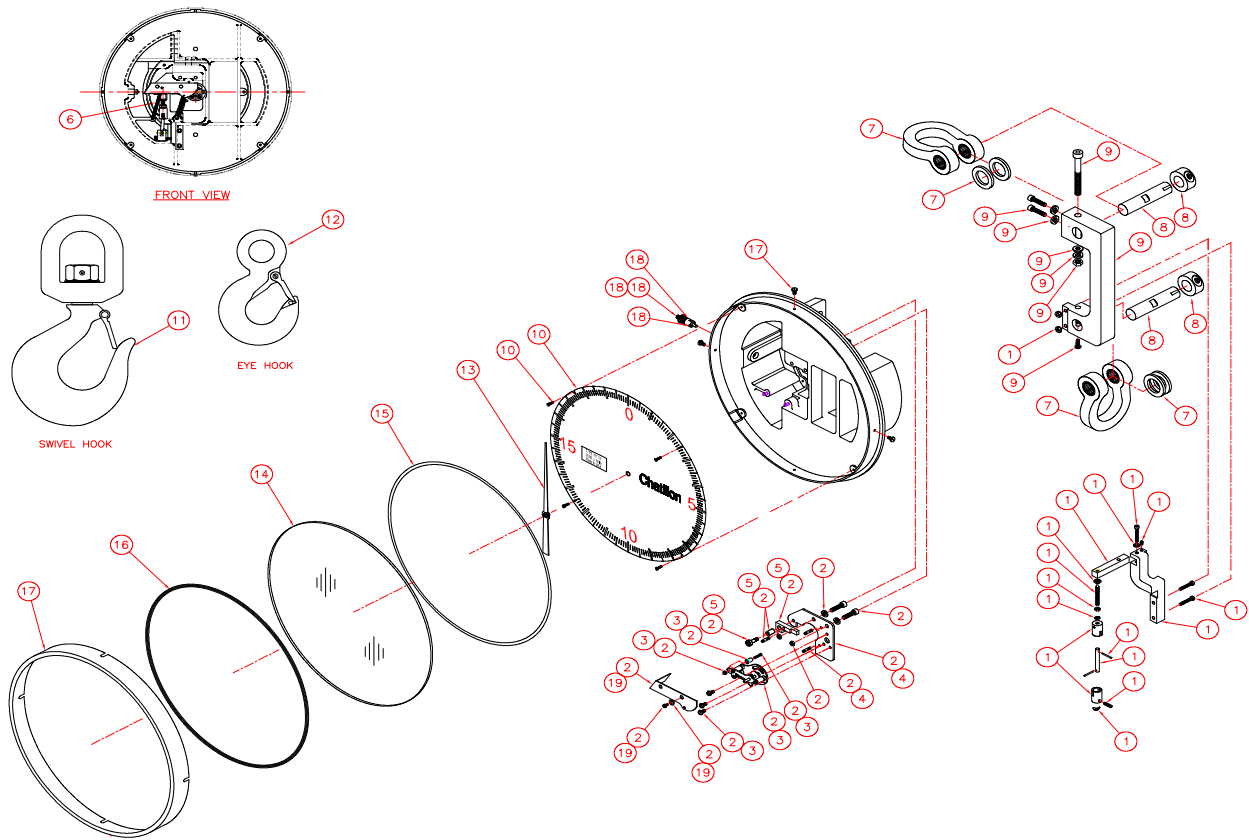

**Note: Spare parts may not be returned for credit or exchange.**

Reference No.	Part No.	Description	Capacity
1	SPK-WT12-001	Zero Adjustment Assembly	
2	SPK-WT12-002	Gear Movement & Plate Assembly	
3	SPK-SCALE-003	Gear Movement Assembly	
4	SPK-SCALE-004	Plate Assembly	
5	SPK-SCALE-005	Lever Assembly	
6	SPK-SCALE-006	Extension Spring	
7	SPK-SCALE-007A	Shackle Assembly, Low Capacity	5000 lb / 2000 kg
	SPK-SCALE-007B	Shackle Assembly, High Capacity	20,000 lb / 10,000 kg
8	SPK-SCALE-008A	Shackle Pin, Low Capacity	5000 lb / 2000 kg
	SPK-SCALE-008B	Shackle Pin, High Capacity	20,000 lb / 10,000 kg
9	SPK-SCALE-009A	C-Spring Assembly	500 lb
	SPK-SCALE-009B	C-Spring Assembly	1000 lb / 500 kg
	SPK-SCALE-009C	C-Spring Assembly	2000 lb / 1000 kg
	SPK-SCALE-009D	C-Spring Assembly	5000 lb / 2000 kg
	SPK-SCALE-009E	C-Spring Assembly	10,000 lb / 5000 kg
	SPK-SCALE-009F	C-Spring Assembly	20,000 lb / 10,000 kg

2013  
Chatillon Scales Price List

<b>Note: Spare parts may not be returned for credit or exchange.</b>					
<b>Reference No.</b>	<b>Part No.</b>	<b>Description</b>	<b>Capacity</b>		
10	SPK-WT12-010A	Dial Face Assembly	500 lb		
	SPK-WT12-010B	Dial Face Assembly	1000 lb		
	SPK-WT12-010C	Dial Face Assembly	2000 lb		
	SPK-WT12-010D	Dial Face Assembly	5000 lb		
	SPK-WT12-010E	Dial Face Assembly	10,000 lb		
	SPK-WT12-010F	Dial Face Assembly	20,000 lb		